

# Dairy Sanitation Solutions

## Product Catalog

# Innovative Dispensing Solutions

- 📍 An ongoing commitment to meeting individual customer needs
- 📍 Worldwide support in multiple languages
- 📍 Worldwide knowledge and compliance with local regulatory requirements
- 📍 100% production conformity – every unit tested before shipping
- 📍 Extensive expertise in corporate customization
- 📍 Product design service & rapid prototype production
- 📍 Comprehensive after-sales follow-up & support
- 📍 Manufactured, sold and serviced in your region

## **Our Locations:**

Australia, Brazil, China, Thailand, United Kingdom & USA

# About us



## **A broad choice - whatever the application**

For 50 years, Hydro Systems has been developing and introducing products that improve chemical performance, reliability and our customers' bottom lines.

We build long-lasting relationships with customers and offer custom, industry-leading solutions that positively impact your business. Hydro is committed to delivering superior customer support and ensuring unparalleled responsiveness to customers around the world. Our commitment to cutting-edge technology, customer satisfaction and safer operations makes us the leader in the chemical proportioning and dispensing industry.

In addition to our North American corporate office, we have manufacturing and distribution facilities in United Kingdom, China, Brazil, Thailand and Australia. No matter where you are, Hydro products are always within your reach.

# Sanitation Solutions for the Dairy Industry



Hydro Systems dispensers and injectors assure worry-free solutions designed for udder health, parlor sanitation, hoof health and countless other dairy applications by consistently and accurately dosing each and every time. Hydro's patented dispensers and proportional injection technology means less waste, plus a better, more dependable mix for cleaners, sanitizers and other water-soluble products.

From teat dip applications, to udder textile towel laundering—and every application in between—Hydro's versatile dispensing systems offer the widest range of flow rates, dilution ranges and sizes to accommodate your needs. It's no wonder more professional dairymen turn to Hydro.

Over the years, our technologies have offered the best dispensers and injectors for the dairy farming professional. Hydro builds long-lasting relationships with our customers and offers custom, industry-leading solutions that positively impact their business.

## **Applications:**

- Udder health
- Hoof health
- On farm laundries
- Parlor sanitation
- Milk system hygiene
- Herd water treatment solutions



# Custom Solutions



Hydro builds long-lasting relationships with our customers and offers custom, industry-leading solutions that positively impact their businesses.

A Hydro sales representative will meet with you to analyze your specific requirements and develop a plan to customize a solution that meets your specific needs. Hydro is committed to delivering superior customer support and responsiveness to you, our partner, and customer.

We understand that challenges and demands vary among operations—sometimes even from barn to barn—and so must your chemical dispensing system performance. Hydro is committed to equipping you with the most dependable, precise solution to your most unique dispensing needs.

Pairing Hydro products with our wide array of ancillary products—often referred to as “**Custom Panel Solutions**”—will further enhance your dispensing process. Your Hydro Dairy Specialist can help you determine the best solution for your operation.

# Technology

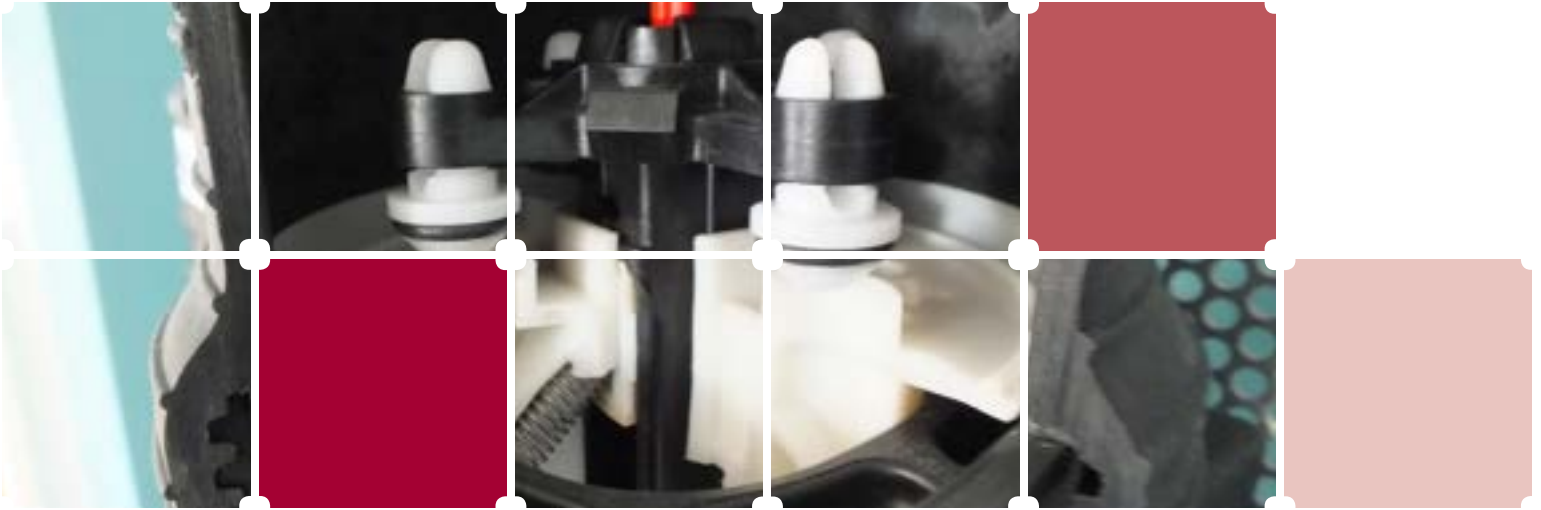

**Venturi** technology

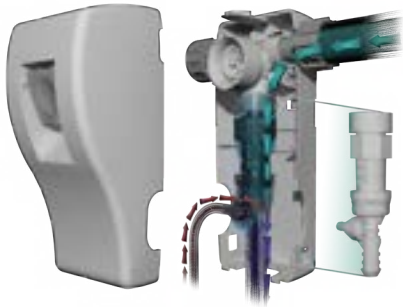

**Volumetric** technology

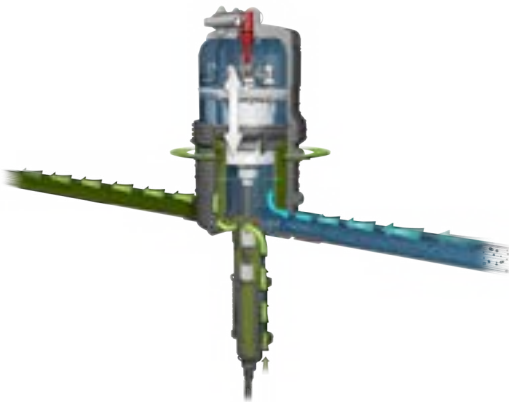

**Peristaltic** technology

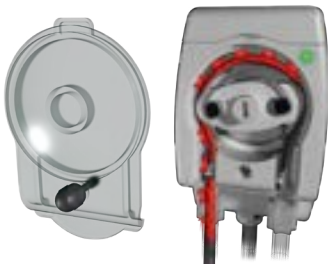

## Three Precise Technologies Perfect For Your Operation

Our expansive product line includes several non-electric, manually-actuated **venturi** dispensers. These dispensers offer a cost-effective way to ensure that products are dispensed accurately and consistently, on demand. Whether it's to fill a mop bucket with a general purpose floor cleaner, a spray bottle with glass cleaner, or your application demands multiple products into multiple containers, **venturi** technology dispensers are ready when you are – at the push of a button!

Volumetric technology is the perfect choice when injecting additives into water streams. These water-driven injectors are designed to reliably operate in the most challenging conditions, making them perfectly suited for use in agriculture and animal health applications where large amounts of water are treated each day. When the water is flowing to troughs and irrigation systems, Hydro **volumetric** injectors are delivering precise amounts of diluted chemicals, sanitizers and, more importantly, peace of mind to the operators.

If your application is more complex and you need chemicals added at very specific times during laundry cycles, **peristaltic** pumps are the perfect fit. Hydro offers several **peristaltic** pumps and controllers that dispense precise amounts of product at exactly the right time, ensuring your operation performs as it should and as your customers expect.

# Venturi Technology

**Venturi** technology (the vacuum created by manipulating the speed of a stream of water) is used to mix chemicals with water. The incoming water stream is restricted by a nozzle, while the speed of the outgoing water is decreased by the inverted funnel shape at the bottom of the venturi. The result is a vacuum in the middle, where the chemical is sucked into

the water stream. The amount of chemical introduced is regulated by interchangeable metering tips that restrict chemical flow into the water stream. The device does not require external electricity, batteries, pumps or air pressure; it works from ordinary water pressure available in most buildings.

# HydroFoamer HydroSprayer

## Overview

**HydroFoamers/Sprayers** eliminate the time and hassle of manually mixing concentrates by increasing labor productivity and concentrate performance while consistently mixing as directed by manufacturers.

The **HydroFoamer's** unique injection concept mixes the proper amount of concentrate with both air and water to produce a thick, rich foam for longer soak time.

**HydroSprayers** produce a fine mist spray suitable for applications of no-rinse sanitizers or products used to cover relatively large areas.

## Features

- Non-electric, no installation required – just fill the concentrate container and connect the dispenser to a water source
- Hose end foamers and sprayers offer automatic dilution with convenient control of where and how the solution is applied



### Perfect For:

- Parlor cleaning & sanitation
- Calf pen cleaning
- Hospital barns

## Models & Specifications

Model	Capacity	Part #	Dilution Range	
			Minimum	Maximum*
HydroFoamer	96 oz. (2.8 L)	481FP	12:1	128:1
HydroFoamer	48 oz. (1.4 L)	483FP	12:1	128:1
HydroSprayer	96 oz. (2.8 L)	381FP	16:1	128:1
HydroSprayer	48 oz. (1.4 L)	383FP	16:1	128:1

\* Leaner dilutions available — contact Hydro Systems for more information: **800.543.7184**.



# HydroChem

## Overview

The **HydroChem** systems dilute and dispense concentrated cleaning products in a foaming and/or spraying mode.

With **HydroChem**, there's no need to mix a bucket of this or a bottle of that. Everything is neat and handy with the **HydroChem**, and switching from one function to the next is just the twist of a handle.

The **HydroChem** is designed for both one product (clean/rinse) or two product (clean/rinse/sanitize) operations. Additionally, it can be mounted to a cart for mobile applications.

The **HydroChem** is available as a wall-mount unit and also as a cart-mounted system, providing maximum mobility and flexibility to your cleaning regimen. (See below for product specs and selection.)



### Perfect For:

- Parlor cleaning & sanitation
- Milk room sanitation
- Hospital barns

## Features

- Chemical-contact components are made of chemical resistant materials, allowing use with acids and aggressive cleaners.
- Built-in check valve prevents chemical from forcing its way into the water line.
- Rinse feature allows you to rinse area after cleaning without an additional hose.

## Models & Specifications

Model	Description	Part #	Flow Rates		Dilution Range	
			Flow (gpm)	Rinse Flow (gpm)	Minimum	Maximum*
HydroChem	1 product, single eductor, with rinse	918FP	3.5	5.0	10:1	512:1
HydroChem	2 products, dual eductor, with rinse	919FP	3.5	5.0	10:1	512:1
HydroChem	1 product, single eductor cart mount	918FPC	3.5	5.0	10:1	512:1
HydroChem	2 products, dual eductor cart mount	919FPC	3.5	5.0	10:1	512:1

\* Leaner dilutions available — contact Hydro Systems for more information: **800.543.7184**.

# FoamMaster

## Overview

**FoamMaster** power cleaning systems automatically dilute concentrated cleaning products with water and use compressed air to generate a thick, rich, clinging foam.

There is no more effective and efficient method for cleaning large areas like rotary and parallel parlors than foam cleaning. This method helps avoid damage done to walls and equipment by high pressure equipment and reduces labor time incurred by traditional cleaning methods.

**FoamMaster** allows you to control air and water flow to deliver the foam thickness you need.

**FoamMaster** comes complete with 25 ft. of heavy-duty discharge hose and brass foam/rinse nozzle with on/off valve to easily reach your intended cleaning area. (Additional hose length available. Ask your Hydro Dairy Specialist for more information.)

## Features

- Chemical-contact components are made of chemical resistant materials, allowing use with acids and aggressive cleaners.
- Built-in check valve prevents compressed air from forcing its way into the water line, allowing you to increase air flow for improved cleaning.
- Rinse feature allows you to rinse area after cleaning without an additional hose.

## Models & Specifications

Model	Description	Part #	Flow Rates		Dilution Range	
			Min. Flow (gpm)	Min. Air Press. (psi)	Min.	Max.*
FoamMaster 890	Wall or cart mount; stainless steel cabinet	890FP	3.0	40	5.5:1	240:1
FoamMaster & Mobile Cart	Stainless steel, cart mounted	890FPC	3.0	40	5.5:1	240:1

\* Leaner dilutions available — contact Hydro Systems for more information: **800.543.7184**.

**Perfect For:**

- Parlor sanitation
- Milk room sanitation
- Hospital barns



Model shown: Model 890C - FoamMaster with cart for mobile applications. Sold as complete system.



# Evolution II

## Overview

The **Evolution II** is a mobile foam generation system operated by compressed air, thereby eliminating the use of electricity which can pose potential risks in wet, humid environments.

The mobility of the **Evolution II** provides total cleaning and efficiently reaches places where manual cleaning would be impossible.

## Features

- Integrated 15 gal clear water tank
- Chemical bottle holders for 1 gal bottles (5" x 7.5")
- Discharge hose assembly, 20' long with foam wand
- The **Evolution II** leaves the factory pre-set to 50 PSI
- Dilution by Venturi (not chemical blended inside the tank)
- Does not require pressurized air, eliminating risks of accidents
- Adapters to fit the equipment to your needs
- Greater autonomy and flexibility of operation
- Automatic dilution of concentrated products

### Perfect For:

- Parlor sanitation
- Milk room sanitation



Back view

Front view

## Models & Specifications

### Model

10094840

90093669

690014BR

10091826

10044305

15-08999-10

671000

503402

90089341

### Description

Unit with integrated tank 15 gal of water

Hose with 25' quick coupler with foam director

Dosing tips kit

Support for chemical drums of 1 gal (5" x 7.5")

Chemical supply line

Pneumatic Flojet Pump

Female brass quick coupler

Air regulator with 80 PSI

Elbow QC for compressed air 1/4 NPT x 3/8"

# AccuPro



## Overview

**AccuPro** proportioners take chemical management to a whole new level. In addition to providing an easy, economical way to dilute concentrated chemicals at a push of a button, the patented **AccuPro** Pressure Regulation Technology delivers dilution accuracy regardless of fluctuations in water pressure.

**AccuPro** is the ideal dispenser for concentrated teat dips and other cleaning chemicals used on your farm. The small footprint allows you to mount the dispenser in or around your parlor for easy access. **AccuPro** is an ideal dispenser for teat cups and buckets.

## Features

- Durable molded construction able to withstand most all concentrated teat dips including iodine
- Easy water connection
- No air need; no electric needed
- Built in flushable filter
- Wide range of dilutions

## Models & Specifications

Model	Eductor	Activation	Flow Rate (gpm)		Approximate Dilution Range 1 gpm Max.* / Min.
			1.0	3.5	
39301FP	E-Gap	Button	1	0	128:1 / 2.5:1
39411FP	E-Gap	Button	2	0	128:1 / 2.5:1

\* Leaner dilutions available — contact Hydro Systems for more information: **800.543.7184**.



# Streamline

## Overview

The **Streamline** Dispensing System delivers the flexibility to dispense concentrated products and provides the flexibility to configure the system as it works best for your dilution rate.

Utilizing patented **AccuPro** pressure regulation technology, **Streamline** systems ensure accurate dilution regardless of water pressure - ensuring optimal product performance.

**Streamline** is an ideal dispenser for teat cups and buckets with metered, concentrated teat dip and hoof baths. The small footprint allows you to mount the dispenser in or around your parlor for easy access.

## Features

- Rugged stainless steel cover
- Lightweight
- Remote gun activation filling
- Simple, easy maintenance
- Wide range of dilutions

## Models & Specifications

	Eductor	Activation	Flow Rate (gpm)	Approximate Dilution Range
<b>Model</b>				<b>3.5 gpm Max.* / Min.</b>
8331FP	E-Gap	Remote nozzle	3.5	350:1 - 3.5:1

\* Leaner dilutions available — contact Hydro Systems for more information: **800.543.7184**.

### Perfect For:

- Udder health
- Parlor sanitation
- Hoof health

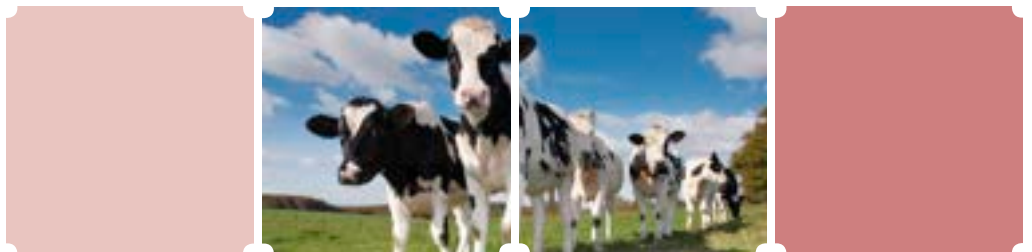

# MultiFlex



## Overview

The **MultiFlex** Dispensing System delivers the flexibility to dispense concentrated products and provides multiple dilution rates which can be configured for your precise needs.

Utilizing patented **AccuPro** pressure regulation technology, **MultiFlex** systems ensure accurate dilution regardless of water pressure - ensuring optimal product performance.

**MultiFlex** is an ideal dispenser for teat cups and buckets with metered, concentrated teat dip and for filling hoof baths with the proper hoof health solution.

Hydro's "pop and latch," mounting bracket allows you to place the chemical dispenser where it fits best within the available installation space.

## Features

- Rugged molded construction for lightweight, durable cabinetry
- Locking cabinets for added security
- Wide range of dilutions
- Constructed with chemically compatible materials
- Remote gun activation filling

## Models & Specifications

### One Button Dispenser

Model	Eductor			Activation		Flow Rate (gpm)	
	QDV	E-Gap	Bottle	Remote Nozzle	Select Valve	1.0	3.5
881800FP		✓	✓		✓	✓	

### Two Button Dispenser

Model	First Button Configuration						Second Button Configuration							
	Eductor		Activation			Flow Rate (gpm)		Eductor		Activation			Flow Rate (gpm)	
	QDV	E-Gap	Bottle	Remote Nozzle	Select Valve	1.0	3.5	E-Gap	Bottle Activated	Remote Nozzle	Select	1.0	3.5	
881418		✓	✓		✓			✓		✓	✓			



**Hydro**<sup>®</sup>  
**systems**

A **DOVER**<sup>™</sup> COMPANY

# Volumetric Technology

## Precise Additive Injection

Proportional positive displacement ensures that just the right amount of chemical is injected each and every time, regardless of pressure and flow. An adjustable ratio sleeve allows you to change the percentages—quickly and easily—to meet your injection needs. Chemical costs are reduced because of less waste in the injection process.

## Safe and Cost-effective

The non-electric **Dosmatic** injectors reduce concerns associated with traditional electrical pumps. The **Dosmatic** injectors use a patented one-way gasket. Only the mixing chamber and the lower end are exposed to the chemical.

This prolongs the life of the motor and the innovative mixing chamber design also ensures a thorough and precise mixing of the fluid and injected chemical. Typically, non-electric injectors significantly reduce start-up and on-going costs over traditional electric injectors.

## Durable Body Construction and Ease of Operation

The **Dosmatic** body is constructed from proprietary engineering grade resins in order to withstand severe weather, harsh chemicals used in injection and high operating pressures. A built-in on/off bypass allows you to stop the injection, but not the system, and an optional remote discharge is available for the whole product line.

# SuperDos

## Overview

The **SuperDos** mid-high flow, fluid (water)-driven proportional injectors offer an ideal alternative to traditional electric technology.

## General Specifications

Housing	Proprietary Engineered Composite Material
Dosing Accuracy	+/- 10% of Ratio
Repeatability	+/- 3% of Ratio
Maximum Temperature	100° F (38° C)
Minimum Temperature	34° F (1° C)
Maximum Vertical Suction of Concentrate	3.6 m
Maximum Horizontal Suction of Concentrate	15 m
Self-Priming	Yes
Seal Material Available:*	Aflas Viton EPDM PAA Resistant Teflon Coated
Maximum Viscosity	1.500 cP (Ex. Honey)
Recommended Accessories	140 Mesh (104 µ) Filter, Check Valve, Pressure Regulator, Flow Restrictor

\* Contact your representative for specific chemical information



### Perfect For:

- Parlor sanitation
- Hoof health
- Udder health
- Water treatment
- Backflush systems



## Models & Specifications\*

Model	Part #		Flow Rate		Operating Pressure		Injection Range	
	NPT	BSP	gpm	l/h	psi	bar	%	ratio
SuperDos 20 0.3%	113228R	113728R	0.04 - 20	9 - 4,500	5 - 100	0.34 - 6.9	0.025% - 0.3%	1:4000 - 1:333
SuperDos 20 2.5%	113205	113705	0.04 - 20	9 - 4,500	5 - 100	0.34 - 6.9	0.20% - 2.5%	1:500 - 1:40
SuperDos 20 2.5% WSP	113205WSP	113705WSP	0.04 - 20	9 - 4,500	5 - 100	0.34 - 6.9	0.20% - 2.5%	1:500 - 1:40
SuperDos 30 0.3%	113229R	113729R	0.15 - 30	34 - 6,800	5 - 100	0.34 - 6.9	0.025% - 0.3%	1:4000 - 1:333
SuperDos 30 2.5%	113209	113709	0.15 - 30	34 - 6,800	5 - 100	0.34 - 6.9	0.20% - 2.5%	1:500 - 1:40
SuperDos 30 2.5% WSP	113209WSP	113709WSP	0.15 - 30	34 - 6,800	5 - 100	0.34 - 6.9	0.20% - 2.5%	1:500 - 1:40
SuperDos 45 0.3%	113230R	113730R	0.50 - 45	113 - 10,000	5 - 100	0.34 - 6.9	0.025% - 0.3%	1:4000 - 1:333
SuperDos 45 2.5%	113212	113712	0.50 - 45	113 - 10,000	5 - 100	0.34 - 6.9	0.20% - 2.5%	1:500 - 1:40

\* This list represents the **SuperDos** models most commonly used in horticulture and irrigation applications; other models are available. Contact your Hydro Systems representative for more information.

## Accessories



### Twist II Clean Filter

**Twist II Clean** is an easy to use, flushable sediment filter. It can remove sand, sediment and organics from the incoming water supply.

**Twist II Clean** removes the need for manual cleaning and does not require the water supply to be turned off.

#### Perfect For:

- Well water systems
- Agricultural and landscape irrigation
- Misting systems on stalls

### Mobile Cart

The **Mobile Cart** is available as an accessory for use with **MiniDos** and **SuperDos** injectors.



# Chemilizer

## Overview

**Chemilizer** is a precision line of volumetric chemical injectors utilizing decades of proven diaphragm technology. Powered by the existing water supply, the internal motor drives the chemical pump, injecting very precise amounts of chemical - either directly back into the flow or to a remote location.

The speed of the motor and pump are proportional to the water flow, ensuring **Chemilizer** will inject consistent amounts of chemical regardless of fluctuation in water pressure and flow. **Chemilizer** injectors are ideal for applications requiring a consistent level of chemical product to be injected into a water line, without the cost and hassle of an electric pump or filter.

**Chemilizer** components are constructed of materials specifically engineered to withstand your most aggressive chemicals.

Because mixing occurs after the pump motor, harsh chemicals never contact the motor parts, prolonging the life of the **Chemilizer** injector.

This proven design makes the unit perfectly suited for hard water conditions, and will handle well water without filtration!



## Models & Specifications

Model	Part # NPT & BSP*	Flow Rate		Operating Pressure		Dilution Range	
		gpm	l/h	psi	bar	%	ratio
HN55 1:128	CH9000-209*	0.02 - 13	5 - 3000	3 - 85	0.21 - 5.9	0.8%	1:128
HN55 1:100	CH9000-210*	0.02 - 13	5 - 3000	3 - 85	0.21 - 5.9	1.0%	1:100
HN55 1:50	CH9000-211*	0.02 - 13	5 - 3000	3 - 85	0.21 - 5.9	2.0%	1:50
HN55 1:64	CH9000-220*	0.02 - 13	5 - 3000	3 - 85	0.21 - 5.9	1.6%	1:64
HN55 1:250	CH9000-222*	0.02 - 13	5 - 3000	3 - 85	0.21 - 5.9	0.4%	1:250
HN55 1:500	CH9000-225*	0.02 - 13	5 - 3000	3 - 85	0.21 - 5.9	0.2%	1:500

\* When ordering British Standard Pipe models, add "bspp" to the end of model number. **Eg: CH9000-209bspp.**



**Hydro**<sup>®</sup>  
**systems**

A **DOVER**<sup>™</sup> COMPANY

# Peristaltic Technology

Peristaltic pumping principle utilizes rollers, controlled by an electric motor, alternating compression and relaxation of a flexible tube to create suction, which squeezes chemical or other fluids in a continuous flow through the pump.

## Ideal For Applications Where Safety Is Key

Peristaltic pumps are used in a wide variety of farming applications. Their unique design makes them especially suited to pumping detergents, acids, sanitizers, aggressive chemicals, as well as other materials where isolation of the product from the environment, and the environment from the product, are critical.

When paired with one of Hydro's many electronic controllers, your peristaltic pump will dispense precise amounts of chemicals at the exact moment you need it. Making the chemical more efficient, and effective.

## Benefits of Peristaltic Pumps:

- **Self Priming** - Hydro peristaltic pumps have extremely good self priming capacity making them ideal for many applications.
- **Withstands debris or particulates** - our peristaltic technology lends itself to farm chemical storage areas where there is a chance for debris or particulates to get into the chemical supply, as they will pass through the pump without problem. \*

\* High quantities of abrasive particles passing through the squeeze tube can greatly increase wear on the inside surface of the squeeze tube.

# Taurus

## Overview

The **Taurus** CP-300 is a fully programmable single pump dispenser designed for use on top load laundry applications as well as any application requiring a single product to be dosed with extreme accuracy.

The **Taurus** CP-300 utilizes Hydro's proven Sprite motor gearbox and squeeze-tube change is easily accomplished with no tools. A universal power supply makes it the right choice regardless of where in the world you are located.

The **Taurus** CP-300 offers a programmable delay of up to 30 minutes in 5 minute increments, a max run time of 20 minutes and programmable lockout period of up to 30 minutes in 5 minute increments. Its programming remote also serves as the User Interface. Once programmed, a simple press of the button begins the dispensing cycle. The **Taurus** CP-300 can be programmed to allow for user priming if desired. Its lockout is protected against power interruptions; the lockout period resumes where it left off once power is restored.



### Perfect For:

- On-farm laundry applications
- Milk System Hygiene - CIP

## Models & Specifications

	Description	Part Number
<b>Model</b>		
CP-300	Single product dispenser	00-08879-00

# Infinity

## Perfect For:

- On-farm laundry
- Milk System Hygiene - CIP

## Overview

The industry's most accurate and useful tattle-tale! A truly modular chemical dispensing system for laundry applications. The **Infinity™** communicates and monitors all components of your system and alerts you when things are not working as they should. Grow your investment in proportion to your revenue stream.

Hydro's **Infinity™** controller is designed to work exclusively with our new **Infinity™** pumping platform. It offers all of the features of the Total Eclipse controller plus serial communication between all components of the system. This serial communication provides real-time monitoring and reporting of exceptions to programmed activities.

The **Infinity™** controller paves the way for a networked solution to On -farm laundry installations.



## Models & Specifications

Part #	Description
00-09200-02	Infinity 2 Pump, 115V, EPDM
00-09200-03	Infinity 3 Pump, 115V, EPDM
00-09200-04	Infinity 4 Pump, 115V, EPDM

# Sprite TL-400

## Overview

The **Sprite TL-400** dispenses two liquid laundry supplies into any top load or small capacity washing machine. The **Sprite TL** promotes the safe and economical use of laundry supplies by ensuring that an accurate amount of chemical is automatically added to every load. The **Sprite TL** allows the user to select from four different programmable formulas so that varying soil loads can be dealt with more effectively. The versatile **Sprite TL** operates either manually or by electronic activation and features a programmable “double-dose” lock-out function.

### Perfect For:

- On-farm laundry
- Milk System Hygiene - CIP



## Features

- Three modes of operation: automatic, sequence or occurrence and push button modes.
- Stopwatch style programming. No need to convert time and ounces.
- Spring loaded spinners resulting in extended squeeze tube life.
- The **Sprite TL** is pre-wired at the factory. There is no need to open the cabinet during normal installation.
- Captive thumb screws on pump covers allow for quick “no tools” squeeze tube changes.
- **Sprite TL** is password protected; a three digit PIN protects your programming from unauthorized access.



## Models & Specifications

### Model

SPL0051

SPL0078

### Description

Dairy Sprite, TL two pump, 115V, PB

Dairy Sprite, TL two pump, 115V, SC

# Custom Panel Solutions



## Perfect For:

- Backflush system
- Hoof health solutions
- Parlor sanitation
- Udder health
- Water treatment



## Overview

Hydro Systems' **Custom Panel Solutions** offer our customers simple, fully assembled systems that are easy to install and maintain. Each solution is built-to-order and can be customized to fit specific needs. Call your local Hydro Dairy Specialist to discuss your options.



## Models & Specifications

Model	Description	Part #	Flow Rate		Operating Pressure		Injection Range	
			gpm	l/h	psi	bar	%	ratio
SD30 0.3%		120330	0.15 - 30	34 - 6,800	5 - 100	0.34 - 6.9	0.025 - 0.3	1:4000 - 1:333
SD45 0.3%	HAC	120340	0.50 - 45	113 - 10,000	5 - 100	0.34 - 6.9	0.025 - 0.3	1:4000 - 1:333
SD80 2.5 %		011394	0.50 - 45	113 - 10,000	5 - 100	0.34 - 6.9	0.020 - 2.5	1:500 - 1:40
SD80 0.3%	With filter	011395	0.50 - 45	113 - 10,000	5 - 100	0.34 - 6.9	0.025 - 0.3	1:4000 - 1:333
SD20 2.5%		120320	0.04 - 20	9 - 4,500	5 - 100	0.34 - 6.9	0.020 - 2.5	1:500 - 1:40
SD20 0.3%	HAC	120325	0.04 - 20	9 - 4,500	5 - 100	0.34 - 6.9	0.025 - 0.3	1:4000 - 1:333
SD30 0.3%	HAC dual system panel	120331	0.15 - 30	34 - 6,800	5 - 100	0.34 - 6.9	0.025 - 0.3	1:4000 - 1:333
SD30 2.5%		120332	0.15 - 30	34 - 6,800	5 - 100	0.34 - 6.9	0.20 - 2.5	1:500 - 1:40
SD45 0.3%	HAC with wand	120341	0.50 - 45	113 - 10,000	5 - 100	0.34 - 6.9	0.025 - 0.3	1:4000 - 1:333

# Specialized Dispensing Systems

perfectly suited for the dairy industry



## TeatBrite

### Overview

**TeatBrite** dispensers offer you the flexibility to dispense ready-to-use (RTU) chemistry for any number of dairy farm applications. Using air operated diaphragm pump technology, **TeatBrite** systems can be mounted hundreds of feet away and are capable of delivering teat dips to parlors, hoof health chemistry to hoof baths or any number of other important dispensing needs.

### Features

- Small profile wall mount
- Quick disconnect air fitting pre-installed

#### Perfect For:

- Udder health
- Hoof baths
- Hospital barns



- Lockable cabinet
- Proven air operated diaphragm pumps

### Models & Specifications

#### Model

SPF0015  
SPF0016  
SPF0017

#### Description

TeatBrite RTU, single pump  
TeatBrite RTU, two pump, pre/post  
TeatBrite RTU, two pump



# ParlorMaster

## Overview

The **ParlorMaster** is designed to provide the flexibility to dispense properly diluted chemicals at the dilution rate that works best for your application.

The **ParlorMaster** contains a 3/4 gallon reservoir holding tank to provide “on demand” dispensing without wasting product. The **ParlorMaster** can be used to spray, foam and fill teat dip containers in your parlor.

The **ParlorMaster** uses Hydro’s patented Venturi technology to accurately dilute your concentrated chemicals.

### Perfect For:

- Udder health



## Features

- Durable molded construction
- Lightweight
- Wide range of dilutions
- Constructed with chemically compatible materials



## Models & Specifications

	Eductor	Activation	Flow Rate (gpm)	Approximate Dilution Range
<b>Model</b>				<b>1 gpm Max.* / Min.</b>
SPF0009	E-Gap	Remote Nozzle	1.0	640:1 / 3:1

\* Leaner dilutions available — contact Hydro Systems for more information: **800.543.7184**.

# Basic Injector Installation

## Temperature and Water Pressure

Install the Hydro injector in a cold water line - no more than 100° Fahrenheit or 38° Celsius - with a water pressure applicable for the model you are installing. Pressure should be regulated to the lowest pressure required for final delivery. Water pressure greater than recommended can cause permanent damage to the injector (Refer to the specifications for the model you are installing).

## Horizontal and Vertical Requirements

Hydro recommends no more than a 15' vertical hose and no more than a 50' horizontal hose from the solution container to the injector (depending on viscosity).

## Importance of a Water Filter

Diaphragm injectors are engineered to withstand harsh water conditions, and therefore, do not require a water filter in most applications.

Piston injectors, however, do require a filter. A water filter prevents debris, such as sand, from entering the motor of the injector which can cause premature failure in the injector. This is especially important if your water source is from a well or pond. Install a 140 mesh/104 micron filter or finer on the inlet side of the injector. Hydro carries **Twist II Clean** filters that can be ordered with your injector.

# Basic Installation

for piston and diaphragm injectors

**inline** installation



**dual remote** injection installation



**bypass** installation



**piston**

**inline** installation



**bypass** installation



**diaphragm**

Depicted are the most common installation scenarios. For a custom solution to your unique application, please contact our product experts.



### Global Headquarters

#### **Hydro Systems Company**

3798 Round Bottom Road  
Cincinnati, OH 45244  
U.S.A.

T 513-271-8800  
F 513-271-0160

[www.hydrosystemsco.com](http://www.hydrosystemsco.com)

### European Office

#### **Hydro Systems Europe**

Unit 3, The Sterling Centre  
Eastern Road  
Bracknell, Berkshire  
RG12 2PW  
England

T +44 (0)1344 488880  
F +44 (0)1344 488879

[www.hydrosystemseurope.com](http://www.hydrosystemseurope.com)

### South America Office

#### **Hydro Systems South America**

Rua Mogiana, 172  
Chácaras Reunidas  
São José Dos Campos  
12238-420SP  
Brasil

T +55 12 3201 7707

[www.hydronovabrasil.com](http://www.hydronovabrasil.com)

### Asia Pacific Offices

#### **Hydro Systems Asia Pacific**

Unit A, 1 Kelham Place  
Glendenning  
NSW 2761  
Australia

T +612 9625 8122  
F +612 9625 8177

#### **Hydro Systems Asia Pacific**

Block #B, No. 51  
Mindong Road  
Pudong New Area  
Shanghai, PRC 201209

T +86 21 61871037  
F +86 21 68727775

#### **Hydro Systems Asia Pacific**

762/2 Room A540  
Rama 3 Road  
Bang Pong Pang  
Yannawa, Thailand

T +66 2 295 2788  
F +66 2 295 2785

[www.hydrosystemschina.com](http://www.hydrosystemschina.com)